

QUICK-LOCK Konturträger für GIVI-Koffer* HONDA VFR 800 V-TEC
QUICK-LOCK Contour Carrier for GIVI Case* HONDA VFR 800 V-TEC

Montagehinweise

Fahren Sie nicht ohne Koffer mit montierten Seitenplatten. Wenn sie ohne Gepäck fahren, Seitenplatten demontieren.

Alle vom Motorrad gelösten Schrauben sind gemäß Herstellerangaben wieder zu montieren, oder mit von SW-MOTECH gelieferten Schrauben zu ersetzen. Falls nicht anderweitig definiert, diese Schrauben nach Tabelle anziehen.

M6	9,6 Nm
M8	23 Nm
M12	79 Nm

Gegebenenfalls Schrauben mit flüssiger Schraubensicherung einkleben.

Prüfen Sie nach 50 km alle Verbindungen auf festen Sitz.

Max. Zuladung 5 Kg pro Koffer.

SW-MOTECH GmbH & Co. KG
Bahnhofstrasse 44d
35282 Rauschenberg
-Germany-

Tel.: ++ 49 (0) 6425 816 800
Fax: ++ 49 (0) 6425 816 810

www.sw-motech.com

Mounting Instructions

German safety regulations require that no metal edge with a radius of less than 2.5mm be exposed while driving a motorcycle. Because Quick-Lock sidecase racks have edges with a radius of less than 2.5mm, Quick-Lock sidecase racks should not be used when luggage is not attached to them.

SW-MOTECH products should be installed by a qualified, experienced motorcycle technician. If you are unsure of your ability to properly install a product, please have the product installed by your local motorcycle dealer. SW Motech takes no responsibility for damages caused by improper installation.

All screws, bolts and nuts, including all replacement hardware provided by SW-MOTECH, should be tightened to the torque specified in the OEM maintenance manual for your motorcycle. If no torque specifications are provided in the OEM maintenance manual, the following torques may be used:

M6	9,6 Nm
M8	23 Nm
M12	79 Nm

All screws, bolts and nuts should be checked after driving the first 50 km to ensure that all are tightened to the proper torque.

Medium strength liquid thread-locker (i.e., "Loctite") should be used to secure all screws, bolts and nuts.

Max. Load 5 Kg (11 lbs) per case.

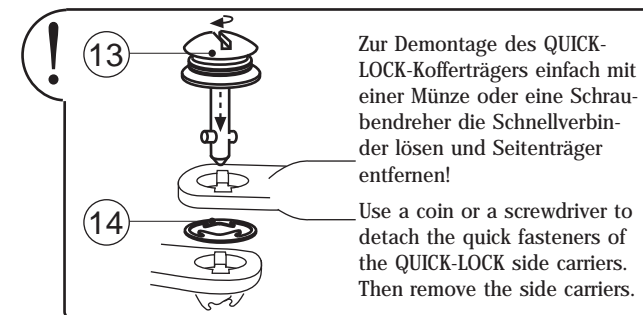
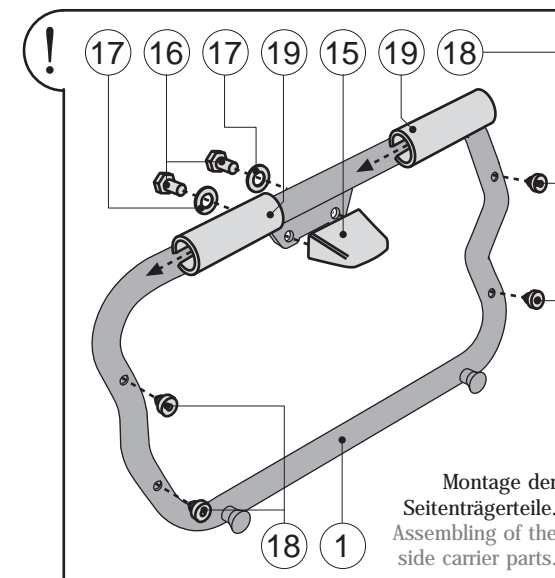

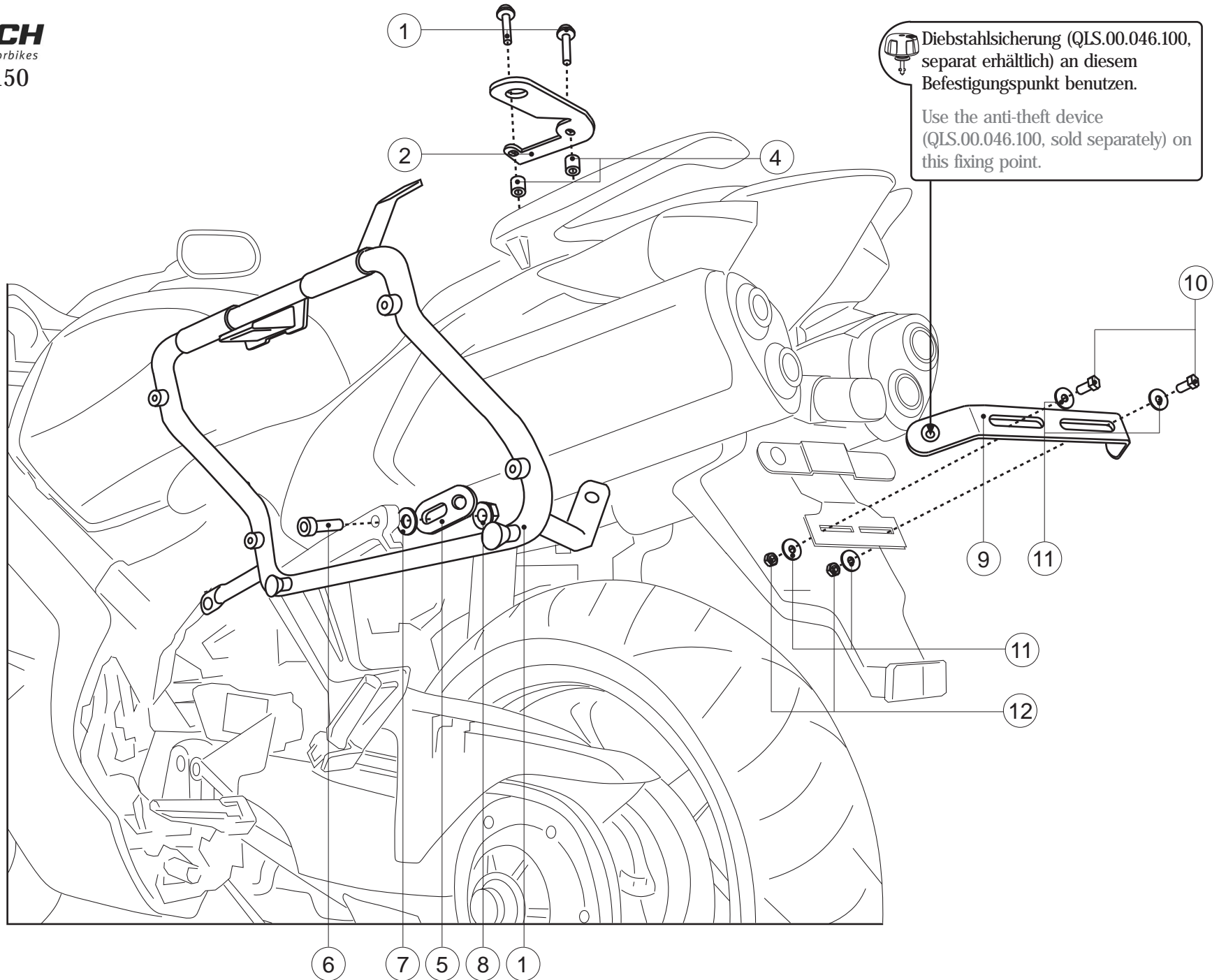

1 Konturträger GIVI
Contour Carrier GIVI

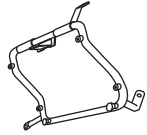

KFT.01.134.951/952 00

Anzahl/ Pcs. 2 (L/R)

5 Befestigungsblech
Fixing Lug



KFT.00.134.001 00

Anzahl/ Pcs. 2

9 Querverbinder
Cross Girder

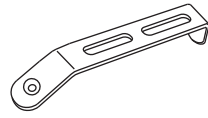

KFT.00.067.002 05

Anzahl/ Pcs. 1

13 Schnellverschluss
mit Federscheibe
Quick Fastener

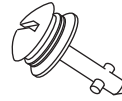

CAM.2312S21-12AHNV

Anzahl/ Pcs. 6

15 Schlossnase GIVI
Lock Pin GIVI

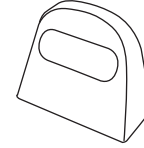

KFT.00.117.009 04

Anzahl/ Pcs. 2

19 Spannhülse
Clamp Sleeve



KFT.00.152.058 01

Anzahl/ Pcs. 4

2 Befestigungsblech
Fixing Lug

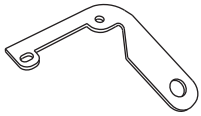

KFT.00.134.002 00

Anzahl/ Pcs. 2 (L/R)

6 Innensechskant-
schraube
Hexagon Socket Screw

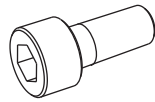

M12 x 40 DIN 912

Anzahl/ Pcs. 2

10 Sechskantschraube
Hexagon Screw

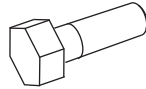

M6 x 20 DIN 933

Anzahl/ Pcs. 2

14 Sicherungsring
Retaining Ring

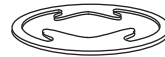

CAM.23.12S10-1BP

Anzahl/ Pcs. 6

16 Sechskantschraube
Hexagon Screw

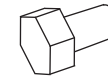

M6 x 12 DIN 933

Anzahl/ Pcs. 4

3 Linsenkopfschraube
Lenshead Screw

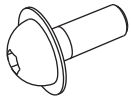

M8 x 50 ISO 7380

Anzahl/ Pcs. 4

7 Unterlegscheibe
Washer



A 13 DIN 125

Anzahl/ Pcs. 2

11 Unterlegscheibe
Washer



A 6,4 DIN 9021

Anzahl/ Pcs. 4

17 Unterlegscheibe
Washer



A 6,4 DIN 125

Anzahl/ Pcs. 4

4 Distanzbuchse
Spacer



Da:20 Di:8,4 h:15

Anzahl/ Pcs. 4

8 Mutter mit Bund,
selbstsichernd
Lock Nut with Flange

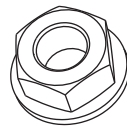

M12 DIN 6927

Anzahl/ Pcs. 2

12 Mutter, selbstsichernd
Lock Nut



M6 DIN 985

Anzahl/ Pcs. 2

18 Gummidämpfer
Rubber Element



KFT.00.152.022 6mm

Anzahl/ Pcs. 8