

## Hauptständer Centre Stand

## HONDA CB 900 Hornet

### Montagehinweise

Alle vom Motorrad gelösten Schrauben sind gemäß Herstellerangaben wieder zu montieren, oder mit von SW-MOTECH gelieferten Schrauben zu ersetzen. Falls nicht anderweitig definiert, diese Schrauben nach Tabelle anziehen.

M6	9,6 Nm
M8	23 Nm
M10	46 Nm

Gegebenenfalls Schrauben mit flüssiger Schraubensicherung einkleben.

Prüfen Sie nach 50 km alle Verbindungen auf festen Sitz.

Die Kurvenfreiheit kann durch einen Hauptständer eingeschränkt werden

SW-MOTECH GmbH & Co. KG  
 Bahnhofstrasse 44d  
 35282 Rauschenberg  
 -Germany-

Tel.: ++ 49 (0) 6425 816 800  
 Fax: ++ 49 (0) 6425 816 810

www.sw-motech.com

### Mounting Instructions

Centerstand cornering clearance:  
 SW-MOTECH centerstands are carefully designed and tested to eliminate reductions in cornering clearance and ground clearance under most driving conditions on an unmodified stock motorcycle, and are certified to be compliant with European ABE safety standards. Use of any centerstand may reduce cornering clearance or ground clearance under extreme driving situations.

SW-MOTECH products should be installed by a qualified, experienced motorcycle technician. If you are unsure of your ability to properly install a product, please have the product installed by your local motorcycle dealer. SW-MOTECH takes no responsibility for damages caused by improper installation.

All screws, bolts and nuts, including all replacement hardware provided by SW-MOTECH, should be tightened to the torque specified in the OEM maintenance manual for your motorcycle. If no torque specifications are provided in the OEM maintenance manual, the following torques may be used:

M6	9,6 Nm
M8	23 Nm
M10	46 Nm

All screws, bolts and nuts should be checked after driving the first 50 km to ensure that all are tightened to the proper torque.

Medium strength liquid thread-locker (i.e., "Loctite") should be used to secure all screws, bolts and nuts.

### 1. Montage des Ständers

**1** Hauptständer  
Centre Stand

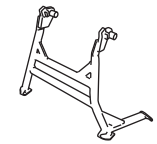



---

HPS.01.109.900

Anzahl/ Pcs. 1

**2** Unterlegscheibe  
Washer





---

A 17

Anzahl/ Pcs. 2

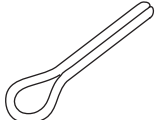
**3** Splinte  
Retaining Pin





---

3.2 x 25

Anzahl/ Pcs. 2

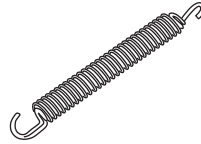
**4** Zugfedersatz  
Spring Set



---

ZFD.00.150.005/ST

Anzahl/ Pcs. 1

### 2. Monage des Anschlagwinkels

**5** Anschlagwinkel  
Buffer





---

HPS.01.109.001

Anzahl/ Pcs. 1

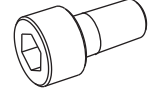
**6** Zylinderschraube  
mit Innensechskant  
Hexagon Socket Screw





---

M8 x 16

Anzahl/ Pcs. 2

**7** Unterlegscheibe  
Washer



---

A 8,4

Anzahl/ Pcs. 2

DIN 125

DIN 912

DIN 125

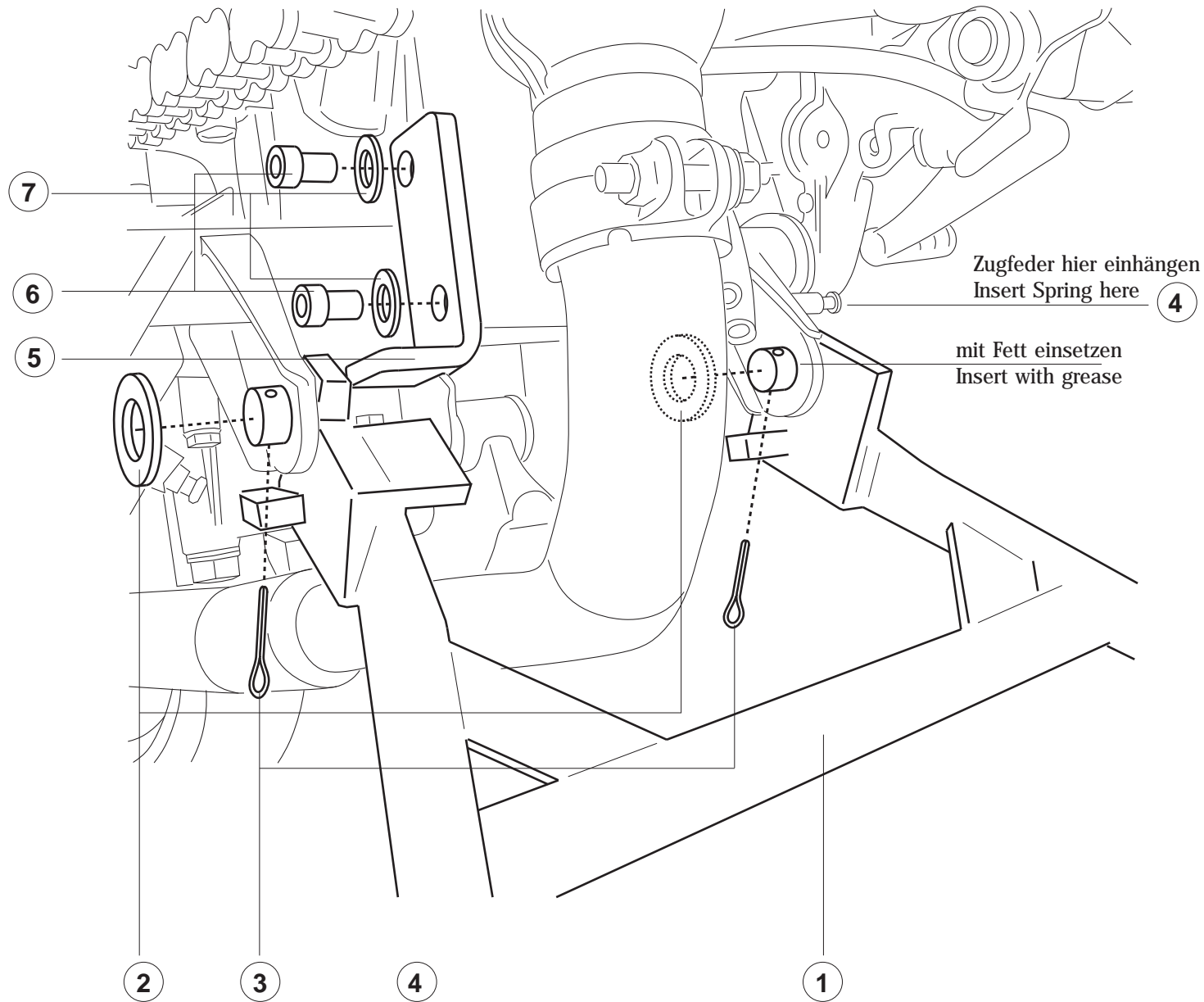

! Alle Schrauben mit Schraubensicherung einsetzen.  
Insert all screws with retainer.

! Achtung:  
Die Kurven- und Bodenfreiheit kann durch einen Hauptständer eingeschränkt werden.  
Attention:  
Cornering and ground clearance can be reduce by using a centre stand.